

1693/57

Ευδοκίη

Καθορισμός περιμετρικῆς γραμμῆς
ἐπὶ οὐνοῦ καὶ πατάδοις
ἢ βοῦζα 07 205

Ἰούλιος 27-2-57

Ἡ καθορισμῆ γραμμῆ γ' ΓΑ δευτέρῃ ἐπὶ τῆς ΑΒΓΔΕΖΗΘΚ
ἑστῆς Α κερὶ καὶ ἐπιπέδῳ τῆς γωνίας Α' Α' ἀρχὴ καὶ κρὶ
τῆς γωνίας Α' 6.50 καὶ κερὶ καὶ ἐπιπέδῳ τῆς γωνίας
ΚΚ' ἀρχὴ ἀπὸ τῆς γωνίας Κ' 6.004. Ἐπιπέδου ΒΒ' = 5.20,
ΓΓ' = 4.63, ΔΔ' = 5.03, ΕΕ' = 3.65, ΖΖ' = 4.57, ΗΗ' = 2.42, ΘΘ' = 1.30

Ἡ γραμμὴ περιτοκίαις δε δευτέρῃ περιμετρικῆς τῶν ἀστῶν
ΛΜΝΞΟΠ καὶ ἀφ' ἑαυτῶν 5.00 μ. ἀπὸ τῶντων, ἐπὶ δευτέρῃ
καὶ ἐπιπέδῳ τῶν κερῶν ΑΛ' ἀρχὴ ἀπὸ τῆς γωνίας Π' 5.00
καὶ κερὶ καὶ ἐπιπέδῳ τῆς γωνίας Π' Π' ἀρχὴ ἀπὸ τῆς
γωνίας Π' 5.00. Ἐπιπέδου ΝΝ' = 4.95, ΝΝ' = 3.60, ΞΞ' = 4.50 καὶ
ΟΟ' = 3.10

Ευδοκίη

6/11/57

Βοηθὸς τῶν ἀστῶν

ΝΙΚ. ΣΑΧΤΟΥΡΗΣ

201

202

203

Т.Т. 1111/17

1690 ВОУНАТМЕННЗ

Т.Т. 07

9-4-64

О.р.к.

У.с.у.т.р.к.

Т.Т. 618/65

204

205

206

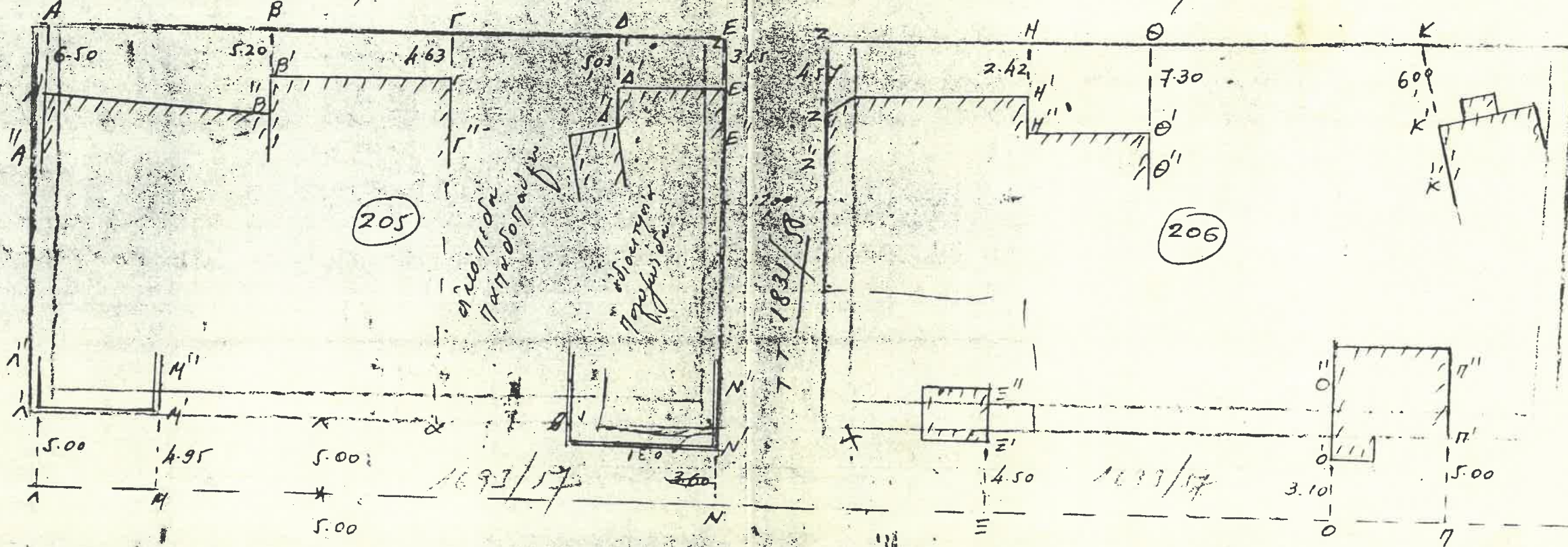

19/810

208

207

Т.Т. 1/501

Т.Т. 1/501